

# O'Pro +

ELECTRIC WATER HEATER

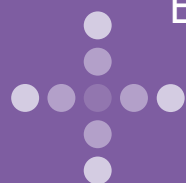

- **New generation diamond-quality enamel**
- New Atlantic design
- **O'Pro technology - Exclusive anti-corrosion system to permanently combat rust**
- **Temperature control for more hot water**
- IP 24 - Full compliance with European standards for electric safety and user protection
- CFC-free high density insulation for more energy savings



## Go diamond-quality, Go Atlantic

# O'Pro +



## Vertical range

Specifications				
Capacity (L)	Output (W)	Voltage (V)	Energy consumption (kWh/24h at 65°C)	Heat-up time at 60°C (Δt=50°C)
30	1 200	230 (220/240)	0.8	1h12
50	2 000		0.95	1h18
80			1.40	2h20
100			1.85	2h48
120	2 200		2.15	3h33
150		1.72	4h36	
200		2.04	5h50	

Dimensions									
Capacity (L)	Dimensions (mm)							Flange opening (Ø) mm	Net weight (kg)
	A	B	C	D	E	F	G		
30	431		235					72	16
50	585		380						20
80	814	433	590	451	165	100	240		22
100	973		740			to 280			29
120	1 127		915						40
150	1 241	505	30	1048	146	473	440	72/112	50
200	1 568								

CE IP 24

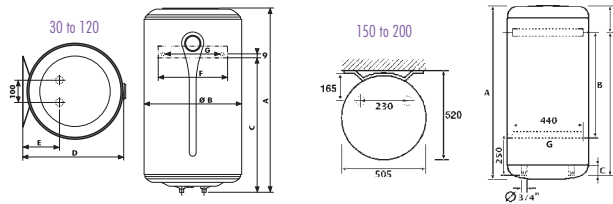

## Horizontal range

Specifications				
Capacity (L)	Output (W)	Voltage (V)	Energy consumption (kWh/24h at 65°C)	Heat-up time at 60°C (Δt=50°C)
50	1 500	230 (220/240)	1.15	1h38
80			1.55	2h38
100			1.95	3h36
150	2 200		1.59	4h20
200			1.96	5h40

Dimensions									
Capacity (L)	Dimensions (mm)						Manhole opening (Ø) mm	Net weight (kg)	
	A	B	C	D	E	F			
50	580		198				72	16	
80	809	433	349	451	234	343		20	
100	968		497					22	
150	1 185	505	800	530	275	440		82 (curved)	40
200	1 490								

CE IP 24

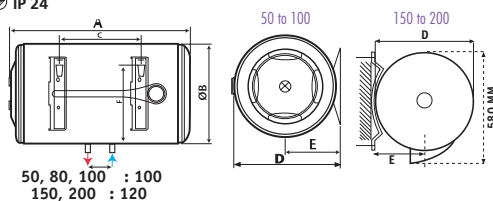

50, 80, 100 : 100  
150, 200 : 120

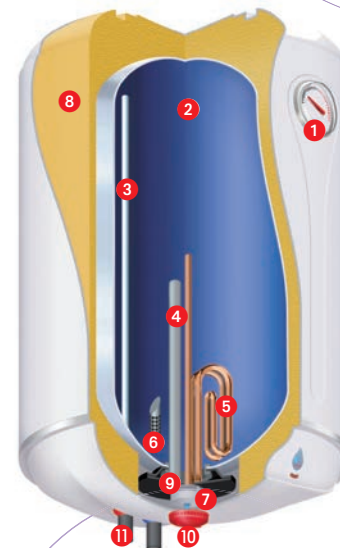

- 1 External thermometer
- 2 Diamond-quality enamel
- 3 Optimised stainless steel outlet pipe
- 4 Magnesium anode
- 5 Sheathed immersion heating element
- 6 Inlet diffuser
- 7 Thermostat
- 8 High density insulation foam
- 9 O'pro System
- 10 Regulation knob
- 11 Dielectric union



### O'Pro System

The Atlantic ohmic resistance ensures EXTRA LIFE for the magnesium anode. Consequence : O'pro system = greater protection = longer tank life.